

RECOMMENDED PCB LAYOUT  
GENERAL TOLERANCE ±0.05

NOTES:

1. MATERIAL:
  - 1.1 HOUSING: THERMOPLASTIC, HIGH TEMP., UL94V-0; COLOR IS Natural.
  - 1.2 CONTACT: COPPER ALLOY
2. FINISH:
  - 2.1 CONTACT: GOLD FLASH OVER ALL
3. IR REFLOW CAPABLE TO 260°C PER ACES SPEC.
4. SPEC. PLS. REFER TO PS-50181-xxxx
5. PACKAGE PLS. REFER TO 51017-xxxxx-00-TRP OR 51017-xxxxx-05-TRP
6. PART NUMBER

51017-XXX X X-XXX

XXX	COLOR	POLARIZATION
001	NATURAL	WITH BOSS & WITH FITTING NAIL
002	BLACK	WITH BOSS & WITH FITTING NAIL

No Of Contact \_\_\_\_\_ Plating  
 Packing \_\_\_\_\_ 1:Gold Flash Over All  
 0:Tape & Reel  
 1:Tube  
 4:Tape & Reel with Mylar  
 5:Tube with Mylar

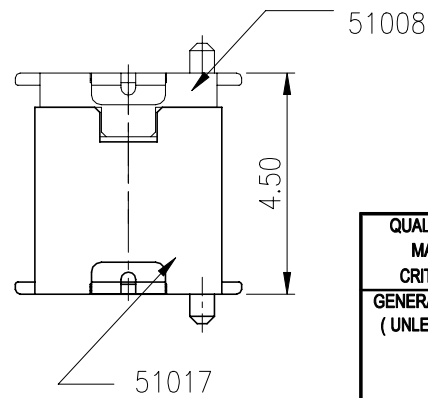
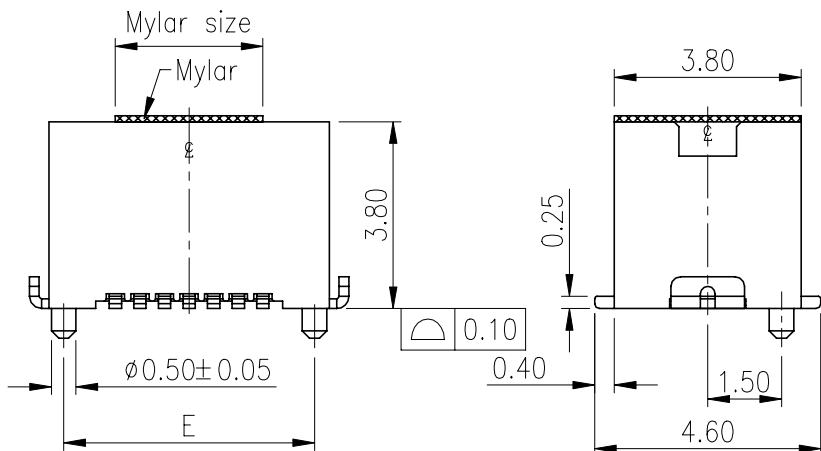

CKT	DIM A	DIM B	DIM C	DIM D	DIM E	DIM F	DIM G	MYLAR SIZE
014	5.7	3.00	3.80	4.20	5.10	3.8	6.5	3
030	9.7	7.00	7.80	8.20	9.10	7.8	10.5	6

<b>QUALITY SYMBOLS</b> MAJOR Ⓜ CRITICAL Ⓢ <b>GENERAL TOLERANCES (UNLESS SPECIFIED)</b> X ±0.5 XX ±0.25 XXX ±0.15 ANGLES ±2°	DRAWN BY Rong, Li Ping 23/05/25	DATE 23/05/25		
	CHECKED BY Lu, Jing Quan 23/05/25	DATE 23/05/25		<b>TITLE</b> 0.5mm B-T-B CONNECTOR PLUG D/R S/T SMT TYPE
	APPROVED BY hsieh, fu yu 23/05/25	DATE 23/05/25		
	UNITS mm			SIZE A4
SCALE 1:1	SHEET NO. 1 OF 1	REV B	DWG NO. 51017-XXXXX-XXX	